

GalvinCare® BS Lead Safe Replacement Cartridge For Safe-Connect Shower Head - 2nd Generation

PRODUCT CODES

- 121.94.06.09

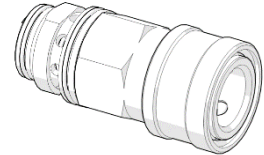

SPECIFICATIONS

- The GalvinCare® Safe-Connect Replacement Cartridge For Safe-Connect Shower Head - 2nd Generation provides an easy reparation solution in case of diverter malfunction.
- Can be used for 2nd Generation Safe-Connect Shower Head reparation only (production date March 2023 and later). See section 'Dimensions' for 2nd Generation recognition details.

IMPORTANT: All GalvinCare® Safe-Connect Showers are tested in accordance with AS/NZS 3662 and leave our premises in good working order.

WARNINGS: Special attentions to be paid on notes, photos, images, or drawings of assembly steps marked with the warning symbol.



DIMENSIONS

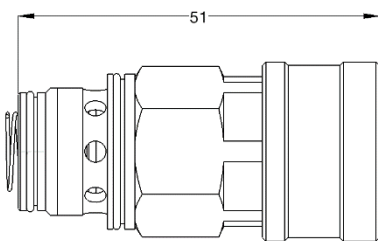

121.94.06.09

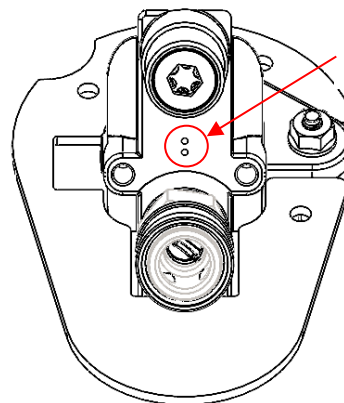
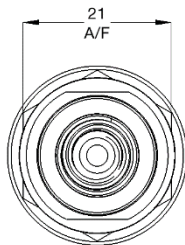

2nd GENERATION MARKING



Before attempting to fix the item, ensure there are two dots marked on the body.

INSTALLATION

INSTALLATION COMPLIANCE: Galvin Engineering products must be installed in accordance with these installation instructions and in accordance with AS/NZS 3500, the PCA and your local regulatory requirements. Water and/or electrical supply conditions must also comply to the applicable national and/or state standards. Failing to comply with these provisions shall void the product warranty and may affect the performance of the product.

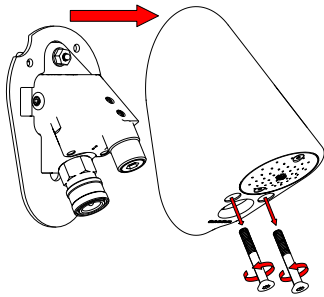

- 1. Remove the cover.**
- Unscrew the two screws as shown on the picture above and remove the cover.

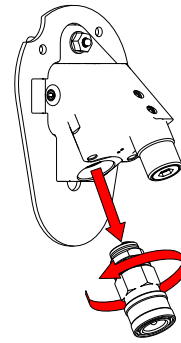

- 2. Remove existing cartridge.**
- Unscrew existing cartridge using spanner 21mm.
 - In case only safe connection is unscrewed, use spanner 16mm to unscrew the remaining components of the existing cartridge.

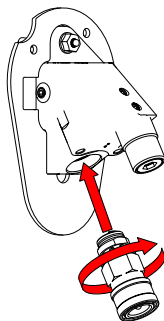

- 3. Install new cartridge.**
- Clean the cartridge seat.
 - Grease two O-rings located on the new cartridge using AS4020 approved grease (we recommend Molykote 111).
 - Screw the new cartridge into the shower body.

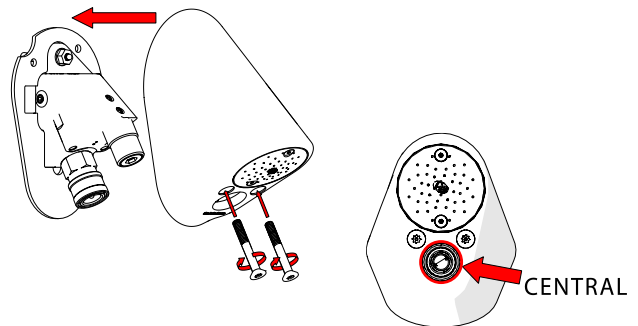

- 4. Fit shower outer case and check operation.**
- Fit the shower outer case onto body as shown.
 - Fit the two screws as shown and tighten evenly to ensure fitting location is central – do not over tighten.
- ⚠ Take care to not shear o-ring on outer case while fitting.**
- Turn on water to check correct function of wall shower, then turn off water.

WARRANTY

The warranty set forth herein is given expressly and is the only warranty given by the Galvin Engineering Pty Ltd. With respect to the product, Galvin Engineering Pty Ltd makes no other warranties, express or implied. Galvin Engineering Pty. Ltd. hereby specifically disclaims all other warranties, express or implied, including but not limited to the implied warranties of merchantability and fitness for a particular purpose.

Galvin Engineering Pty Ltd products are covered under our manufacturer’s warranty available for download from www.galvinengineering.com.au Galvin Engineering Pty Ltd expressly warrants that the product is free from operational defects in workmanship and materials for the warranty period as shown on the schedule in the manufacturer’s warranty. During the warranty period, Galvin Engineering will replace or repair any defective products manufactured by Galvin Engineering without charge, so long as the terms of the Manufacturer’s warranty are complied with.

The remedy described in the first paragraph of this warranty shall constitute the sole and exclusive remedy for breach of warranty, and Galvin Engineering Pty Ltd shall not be responsible for any incidental, special or consequential damages, including without limitation, lost profits or the cost of repairing or replacing other property which is damaged if this product does not work properly, other costs resulting from labour charges, delays, vandalism, negligence, fouling caused by foreign material, damage from adverse water conditions, chemical, electrical or any other circumstances over which Galvin Engineering has no control. This warranty shall be invalidated by any abuse, misuse, misapplication, improper installation or improper maintenance or alteration of the product.

Within Australia: 1300 514 074 Outside Australia: P: +61 (0)8 9338 2344

F: +61 (0)8 9338 2340

sales@galvinengineering.com.au

www.galvinengineering.com.au

ABN: 78 008 719 382

PERTH | SYDNEY | MELBOURNE | BRISBANE | ADELAIDE

